

# When would you need to do this:

- If the glass doors need replacement or realignment



# Disassembly



Remove the four bolts from the side panel, while holding the glass door

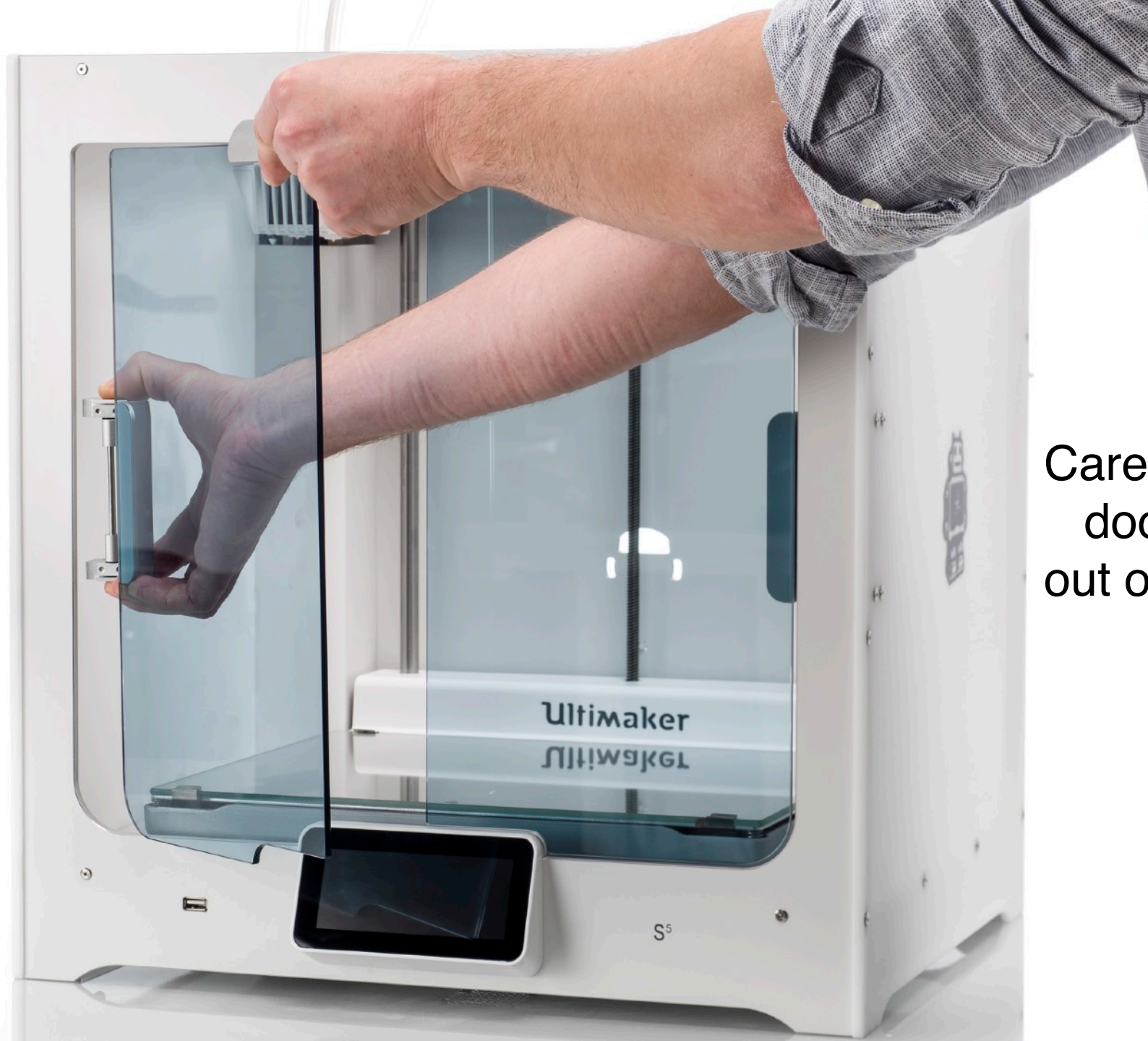

Carefully take the door assembly out of the printer

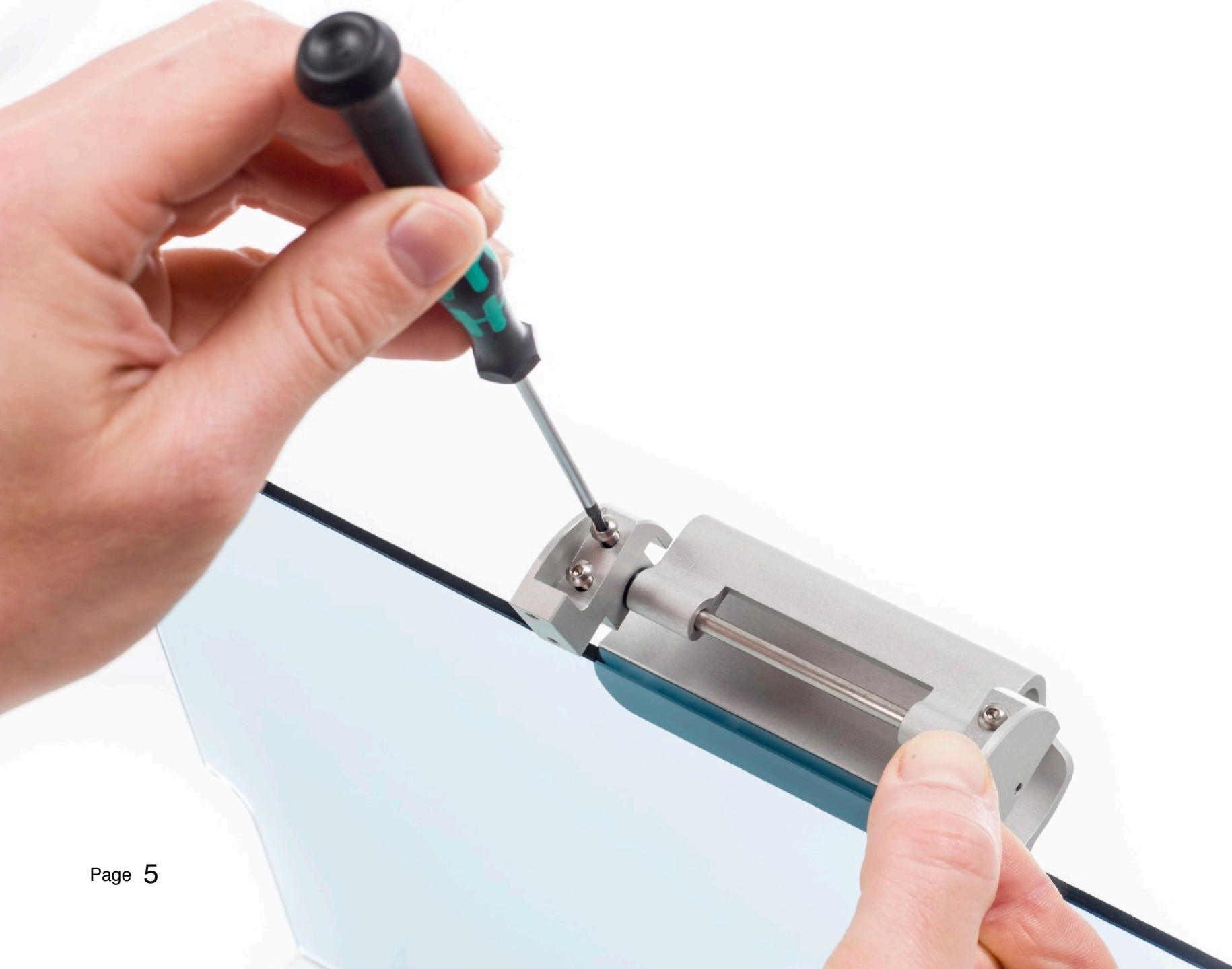

Loosen the four bolts that hold the hinge mounts

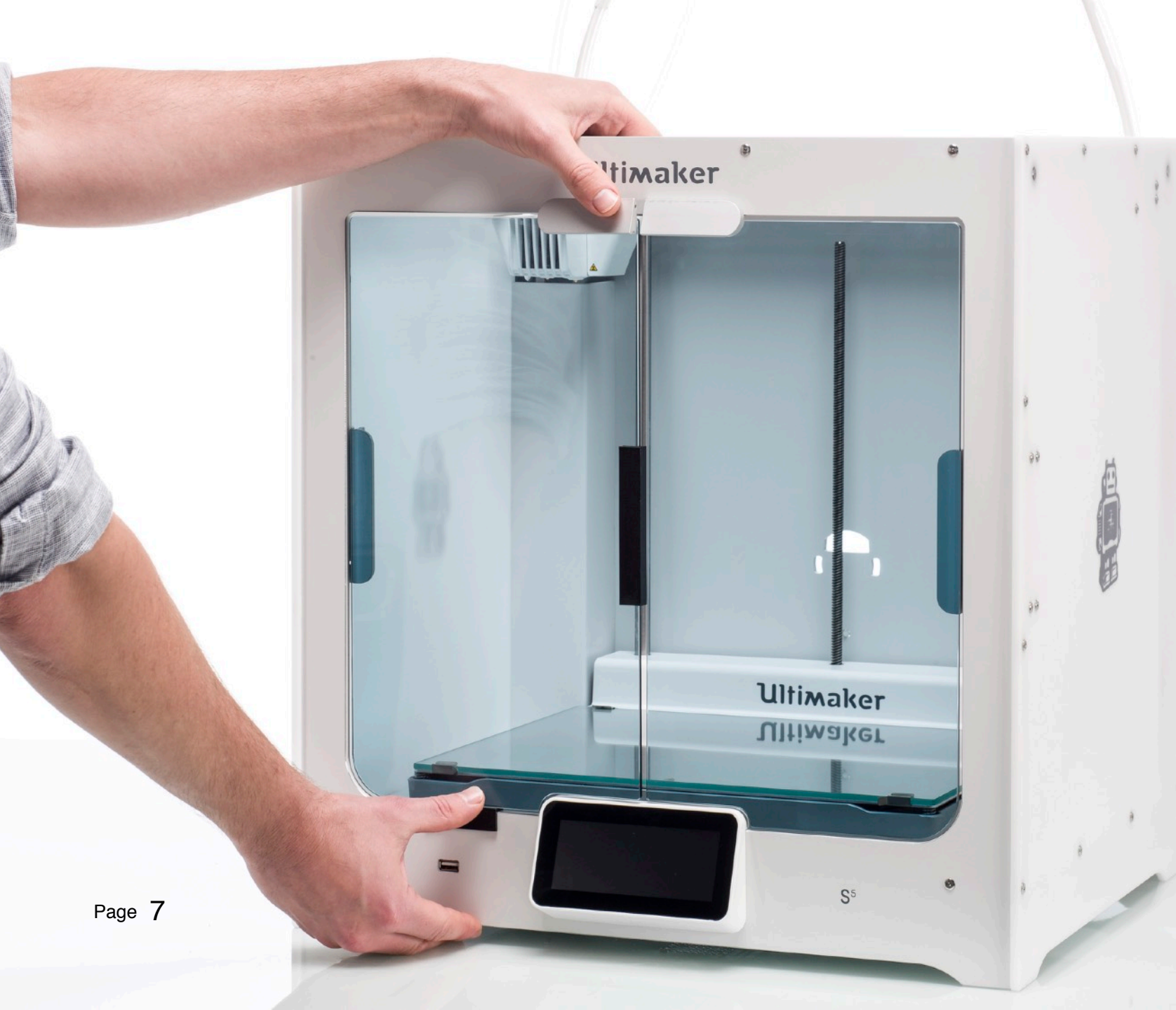

# Reassembly

(To be done after  
you have finished  
replacing the camera)



Insert the four  
M3x12 flathead  
bolts through the  
side panel



Carefully place the door assembly in the correct location





Align the hinge  
with the bolts



Loosely tighten  
the four bolts



Place the alignment  
tool bottom  
onto the front panel



Place the alignment tool middle onto the glass door

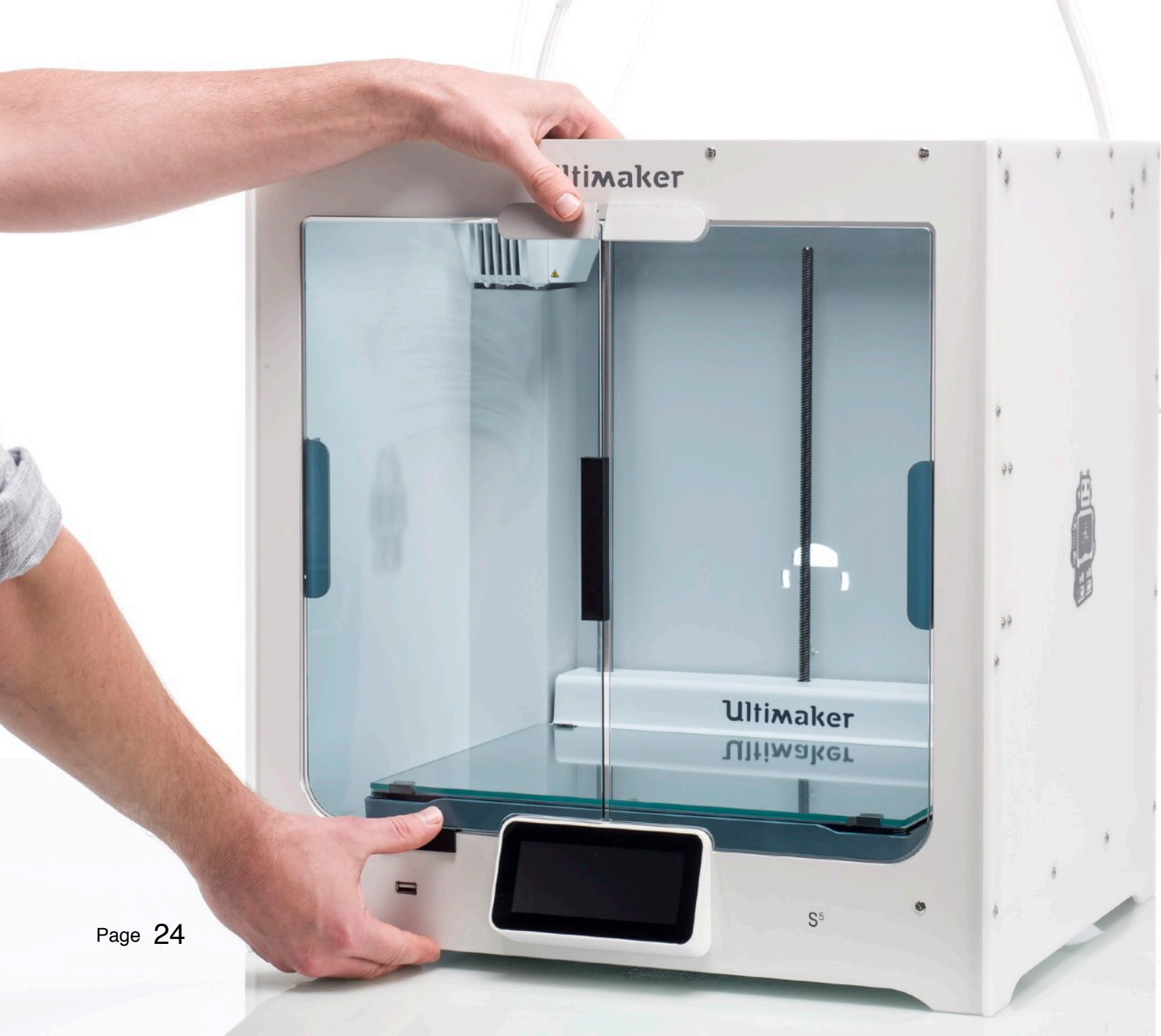

Gently push the door closed

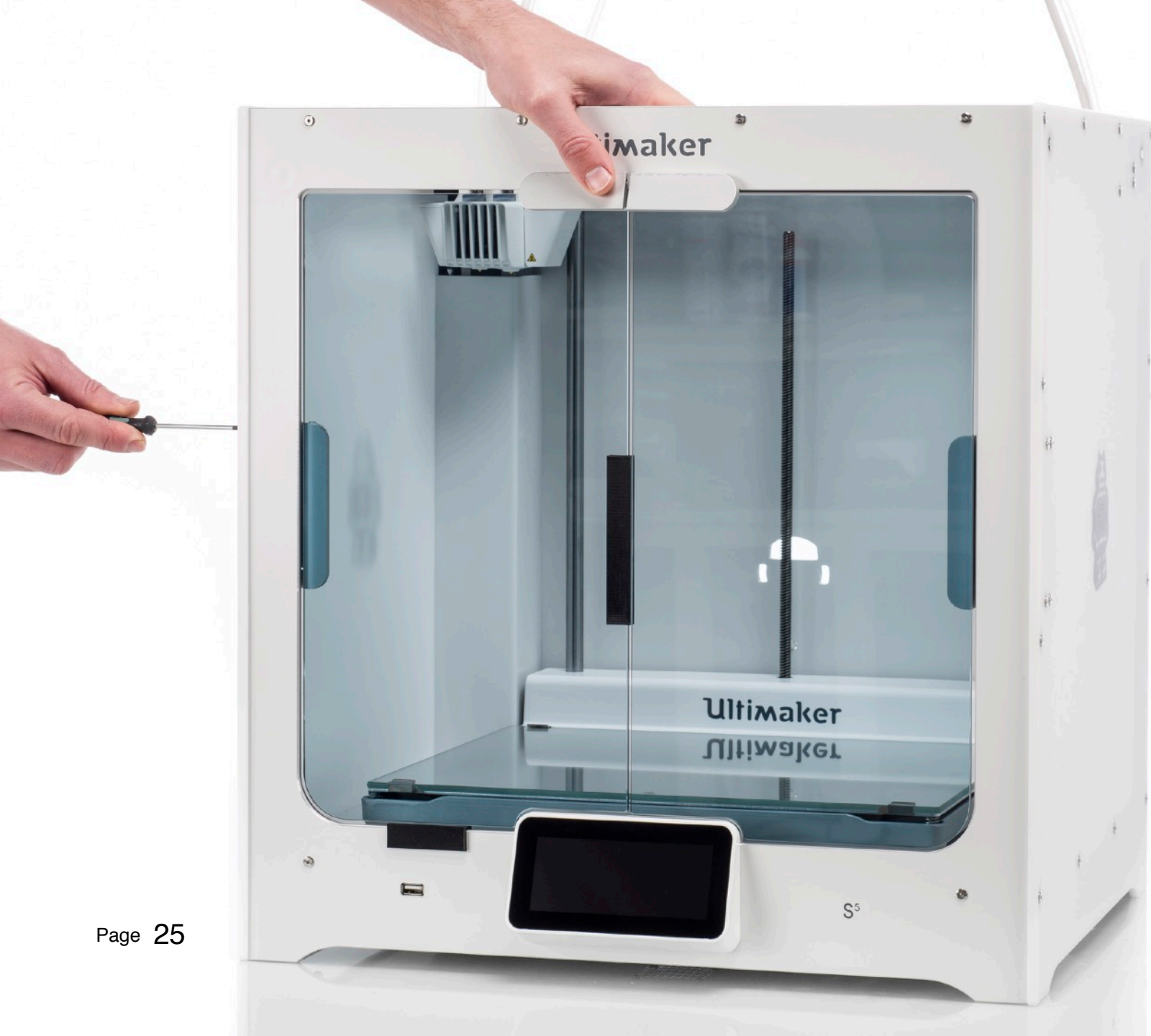

Keep the door in  
the correct location  
and tighten the four  
bolts in the side panel



Tighten the four bolts on the inside of the hinge

A close-up photograph of the top edge of a machine's door. The door is a light grey color and features the 'Ultimaker' logo in a dark, bold, sans-serif font. Below the logo is a horizontal metal handle with rounded ends. Two screws are visible on the top surface of the door, one on either side of the logo. The background is a plain, light-colored surface.

# Ultimaker

Check the alignment of the two doors